





















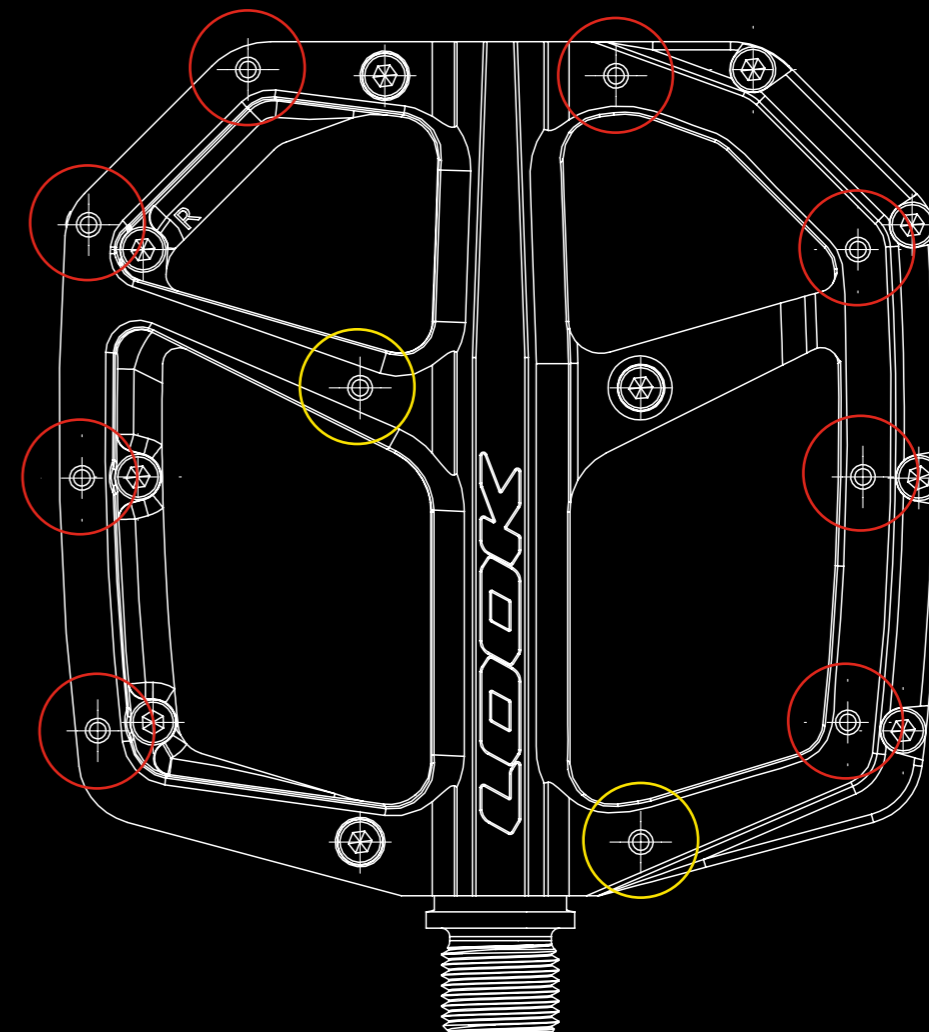
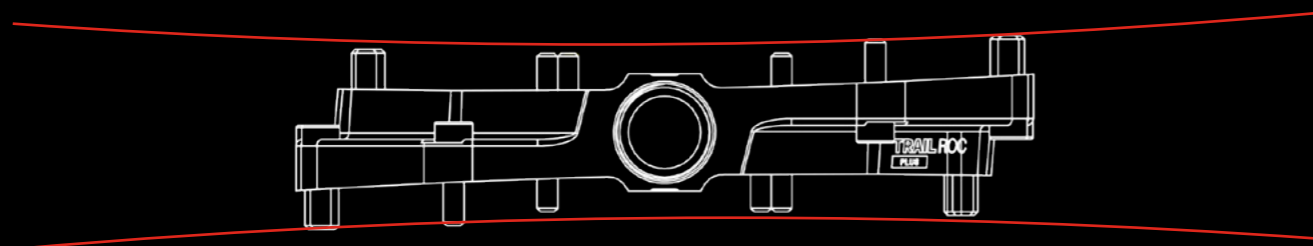

# Outstanding grip

10 replaceable pins on each face of the TRAIL ROC + pedal provide optimal grip and traction. Their positioning is designed to secure the foot in the most extreme positions, allowing you to push the limits of your bike and the trail with confidence.



**+** Concave body shape + pins length to secure foothold

**+** Bike park set up validated for commercial version with Thomas Genon.

-  Outer pins / 3mm
-  Inner pins / 1,5mm











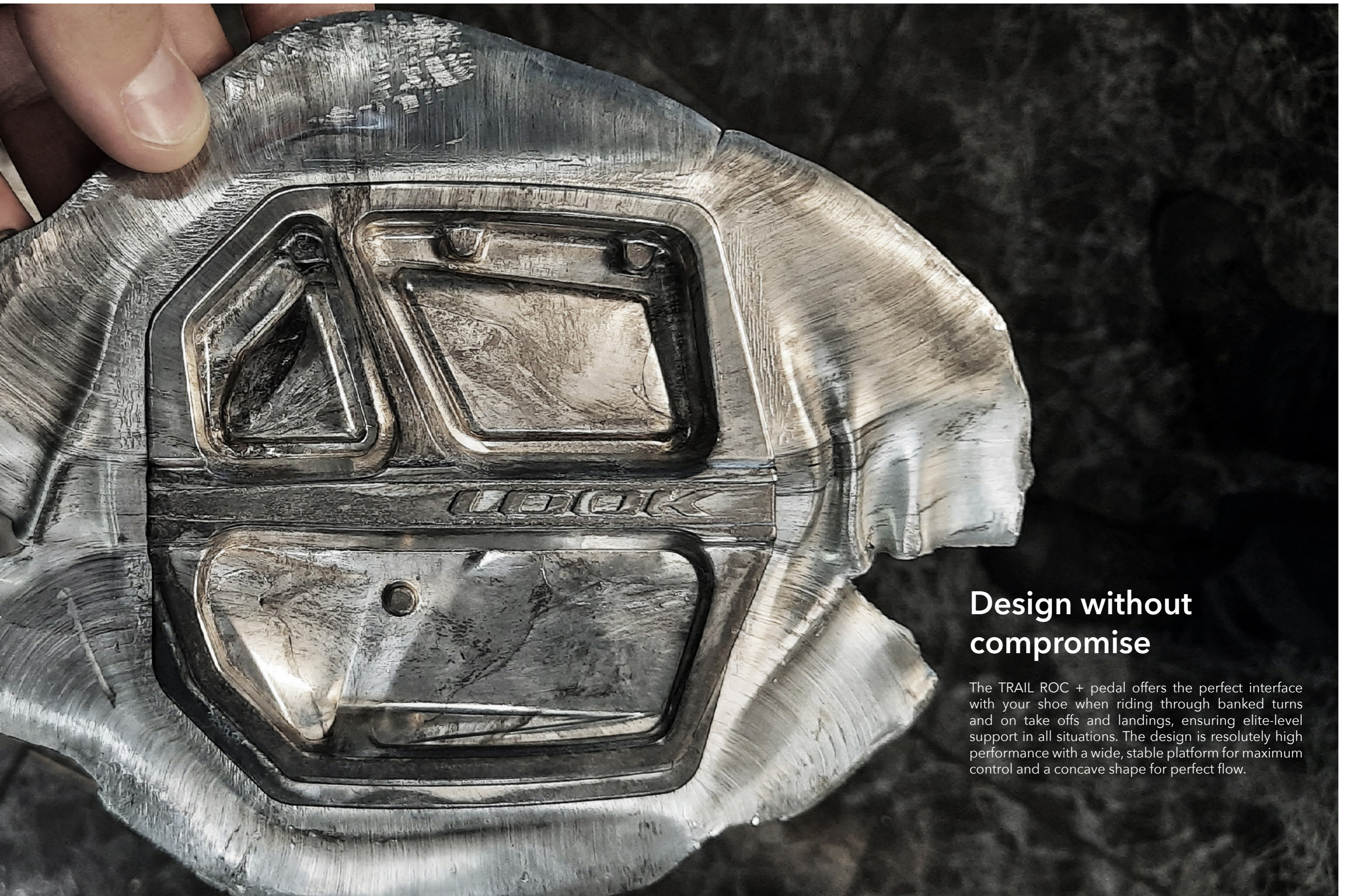

## Design without compromise

The TRAIL ROC + pedal offers the perfect interface with your shoe when riding through banked turns and on take offs and landings, ensuring elite-level support in all situations. The design is resolutely high performance with a wide, stable platform for maximum control and a concave shape for perfect flow.



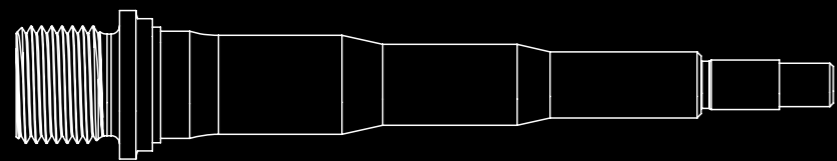

**+** Premium seal system

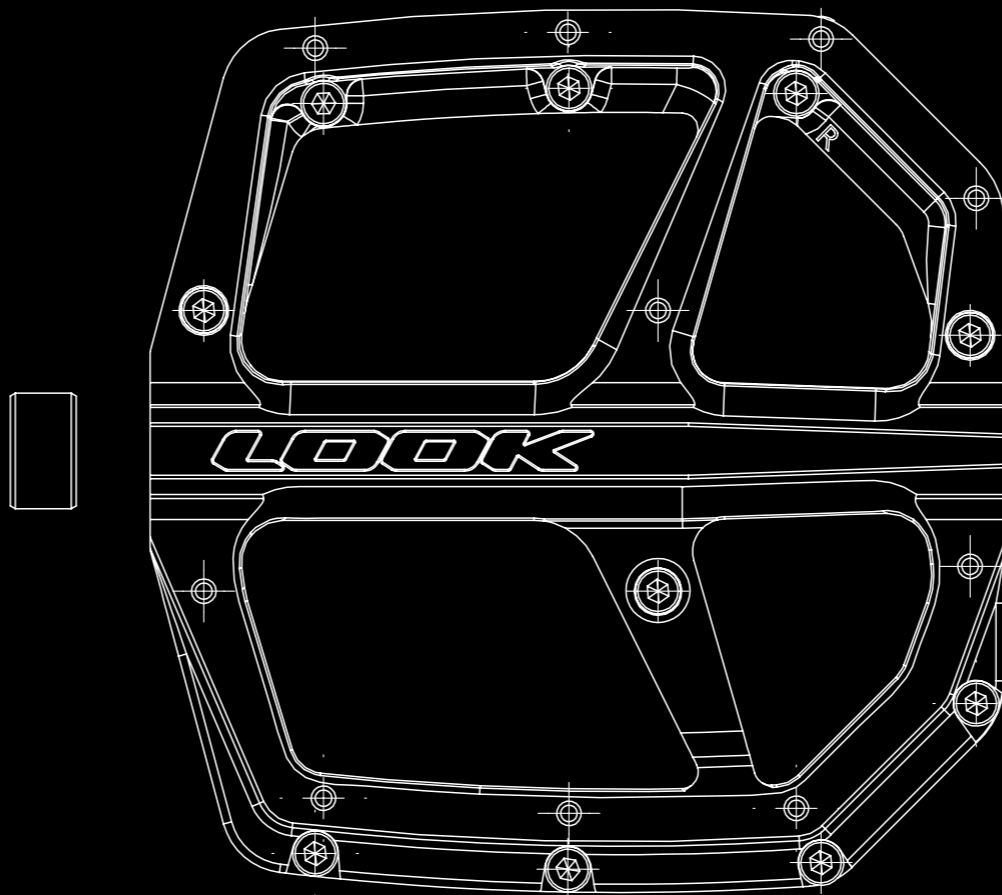

**+** High durability Chromoly+ axle

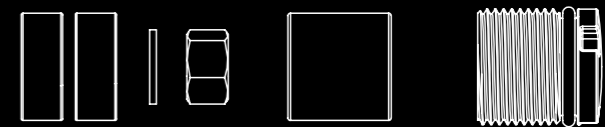

**+** Premium double ball bearings + plain bearing system





## Made By LOOK

**With 35 years of experience** in manufacturing pedals, we put the TRAIL ROC + through the toughest tests.

**Our testing begins in our quality lab, where they passed 15 tests. The TRAIL ROC + survived hundreds of hours of fatigue tests and resisted the harshest shock tests.** We take pride in our products, our standard range of tests are unparalleled and well above the ISO required standards. This rigorous process has enabled us to build durable and robust pedals.

After the lab we moved into field testing, spanning nearly half a year. Under the feet of our athletes the pedals were, and continue to be pushed through the most demanding competitions, such as the Red Bull Rampage.









### Features / Especificaciones

Technology / Tecnología	Flat Pedals
Body / Cuerpo	Forged Alloy
Grip / Grip	10 Metal Pins Per Side
Spindle / Eje	Chromoly +
Surface Area / Superficie	107x107 mm
Q Factor	61,5 mm
Profile / Perfil	16 mm
Weight (Pedal) / Peso Del Pedal	197 g
Weight Pair / Peso Par De Pedales	395 g

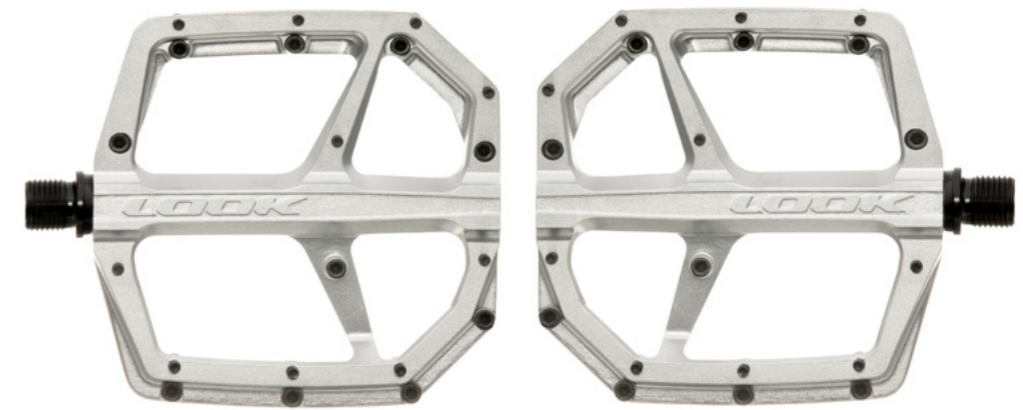

### Features / Especificaciones

Technology / Tecnología	Flat Pedals
Body / Cuerpo	Forged Alloy
Grip / Grip	10 Metal Pins Per Side
Spindle / Eje	Chromoly +
Surface Area / Superficie	107x107 mm
Q Factor	61,5 mm
Profile / Perfil	16 mm
Weight (Pedal) / Peso Del Pedal	197 g
Weight Pair / Peso Par De Pedales	395 g





### Features / Especificaciones

Technology / Tecnología	Flat Pedals
Body / Cuerpo	Forged Alloy
Grip / Grip	10 Metal Pins Per Side
Spindle / Eje	Chromoly +
Surface Area / Superficie	107x107 mm
Q Factor	61,5 mm
Profile / Perfil	16 mm
Weight (Pedal) / Peso Del Pedal	197 g
Weight Pair / Peso Par De Pedales	395 g

### TRAIL ROC +

- + Best Grip & **Traction**
- + Durable & **Serviceable**
- + More **Color**
- + Made in **France**



**+** Off Road Range **+**

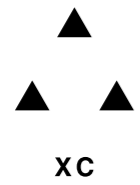

**X-TRACK**



**X-TRACK EN-RAGE**



**TRAIL ROC +**



**TRAIL ROC**



**TRAIL FUSION**



