



QUICK START

GEO TREKKING
VISION

lookcycle.com

1

RECHARGE BEFORE FIRST USE

Charging time = 50min

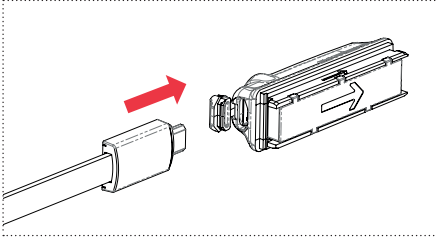

● charging

● charge completed

2

MOUNTING

- Choose the side where you want to mount the lighting device
- Insert the metal tool included in the box into pinhole above the side cover [A]
- Gently press on the metal tool then remove the side cover [B]
- Remove the reflector [C]

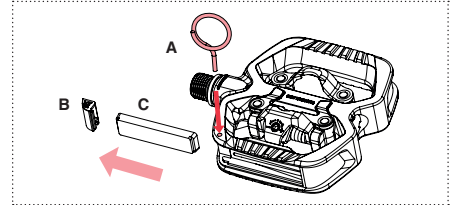

- Insert the lighting device in the correct direction / insert the side cover "click"

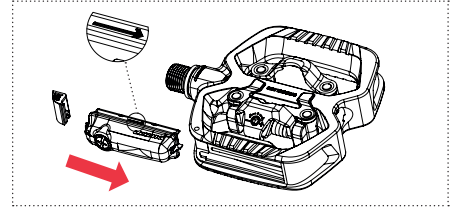

3

USE

- LONG PRESS (1s) > turn light on and off
- SHORT PRESS > Cycle through the modes

- MODE 1 > steady (5h)
- MODE 2 > flash (10h)
- MODE 3 > flash eco (30h)

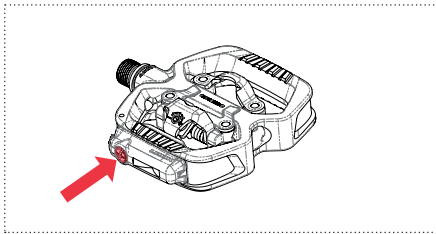

4

DISASSEMBLY

- Insert the metal tool included in the box [A] in the small pedal pinhole above the side cover
- Apply a small amount of pressure to release the side cover
- Remove the side cover and pull the light out [B]

